

THIS DRAWING REMAINS THE COPYRIGHT OF OBJEK (PTY) LTD.

ALL DIMENSIONS ARE IN "mm" UNLESS OTHERWISE INDICATED.

DO NOT SCALE THIS DRAWING.

ALL RELEVANT DETAILS, LEVELS AND DIMENSIONS ARE TO BE CHECKED ON SITE PRIOR TO COMMENCEMENT OF WORK

RC STRUCTURE TO STRUCTURAL ENGINEER'S DETAIL AND SPECIFICATION

ALL PENETRATIONS THROUGH STRUCTURAL ELEMENTS TO BE VERIFIED WITH RELEVANT CONSULTANTS.

ALL WORK TO BE CARRIED OUT STRICTLY IN ACCORDANCE WITH NATIONAL BUILDING REGULATIONS AND LOCAL AUTHORITY REGULATIONS.

THE ARCHITECT ACCEPTS NO RESPONSIBILITY FOR ERRORS RESULTING FROM MISINTERPRETATION OF THE DRAWINGS

ANY DISCREPANCIES TO BE REPORTED TO THE ARCHITECT IMMEDIATELY

Dimensions subject to variations on site

REVISIONS

REV	DATE	DESCRIPTION
1	2016_07_01	For Tender
2	2016_10_10	General update
3	2016_10_26	General Update
4	2017_04_26	General revision, drainage channel along north facade

VICTORIA ROAD

ARMADALE STREET

RAVENS CRAIG ROAD

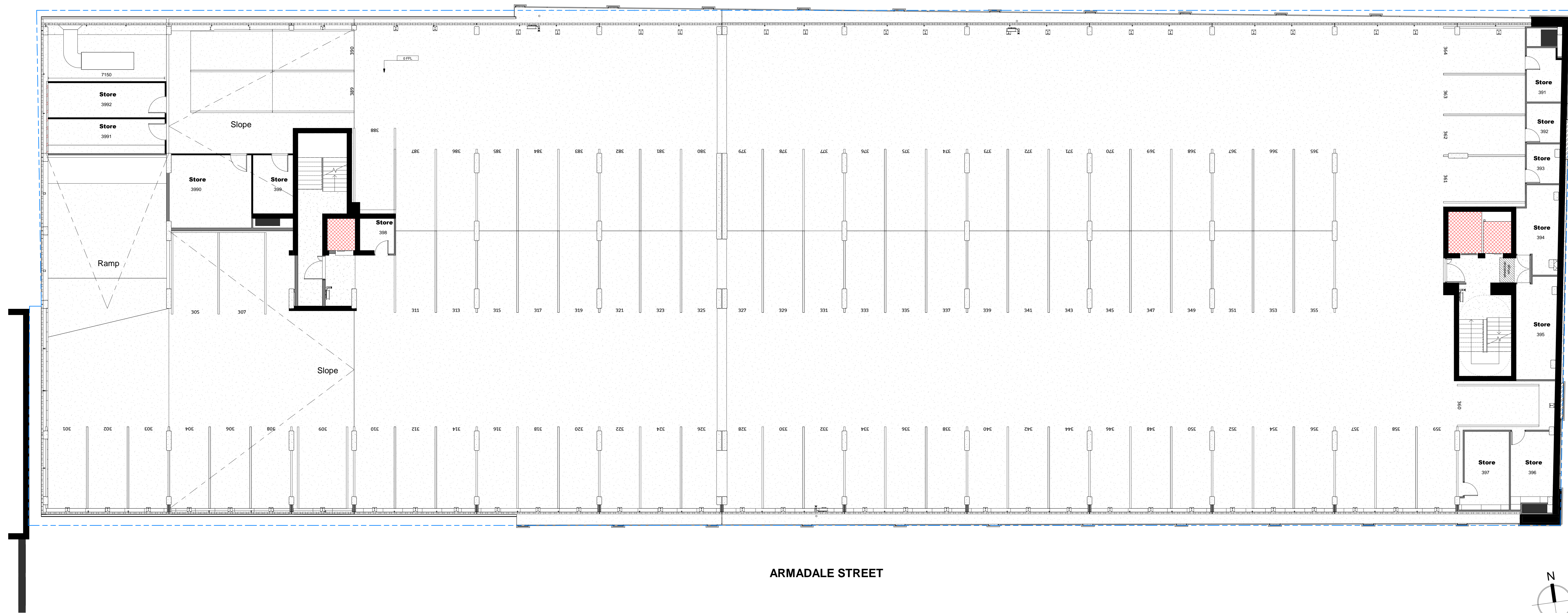

OBJEK:
ARCHITECTS | INTERIORS | DESIGN
114 broe street | 8001
021 461 3759
info@objek.co.za

THE IRON WORKS

MIXED USE DEVELOPMENT

CONSOLIDATED ERF 178263 (12054, 12055, 12056, 12057)

1 ARMADALE ROAD, WOODSTOCK

TENDORITE (PTY) LTD

THIRD FLOOR PLAN

INFORMATION

PROJECT NO.	DRAWING NO.	REVISION NO.
1512	20_704	4

SCALE	DRAWN	CHECKED
As indicated	Author	Checker

ISSUE DATE
07/08/2018 3:06:29 PM